

## Type L20, L35

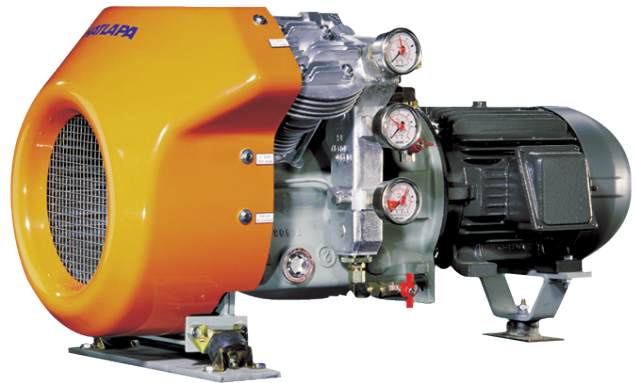

### STRUCTURAL FEATURES:

- Two staged cylinders in 90° V-arrangement, with one-throw crankshaft, single acting trunk pistons
  - 1st stage: 1 cylinder
  - 2nd stage: 1 cylinder

### VALVES:

- Combined suction and pressure valves for both stages

### AIR COOLING:

- By radial fan directly driven by the crankshaft

### INTERCOOLER AND AFTERCOOLER:

- Finned pipes

### FORCE FEED LUBRICATION:

- Gear pump directly driven by the crankshaft
- Oil pressure control by means of pressure gauge and pressure switch
- Oil level inspection glass
- Crankcase venting from oil filler to air suction filter

### BEARINGS:

- **Crankshaft:** Slide bearings
- **Connecting rod:** Slide bearings
- **Wrist pin 1st stage:** Slide bearings
- **Wrist pin 2nd stage:** Needle bearings

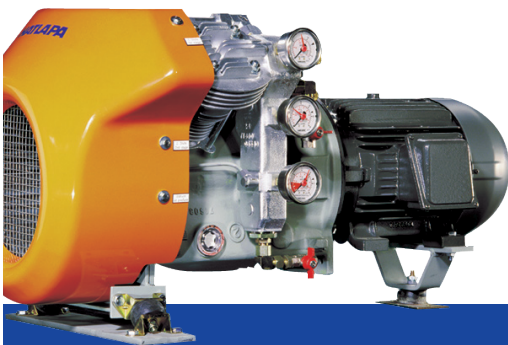

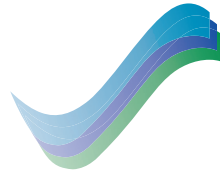

## Type L20, L35

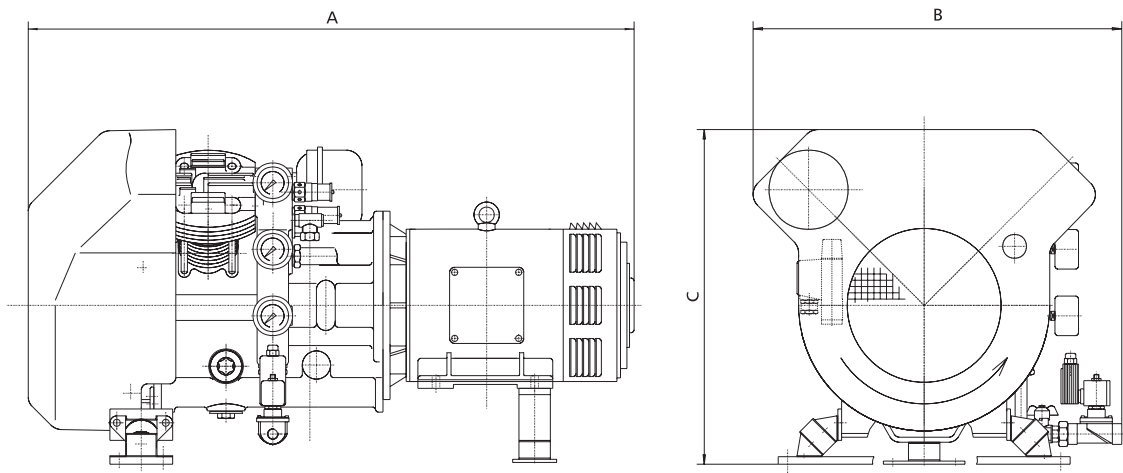

Type	Cylinders	Stage	Speed r.p.m.	F.A.D m <sup>3</sup> /h	Power kW	Weight incl. e-motor approx. kg	Dimensions		
							A	B	C
L20	2	2	1150	16.5	3.9	180	950	540	570
			1450	20.5	5.3	180	950	540	570
			1750	25	6.3	180	950	540	570
L35	2	2	1150	24	5.0	200	975	590	530
			1450	31	6.6	200	975	590	530
			1750	38	8.2	200	975	590	530

All data apply to a final pressure of 30 bar. The right for alteration of specification and data to incorporate improvements in design is reserved.

- Motor ①
- Flywheel and coupling ②
- Solenoid valve for draining ③
- Non-return valve ④
- Pressure switch ⑤
- Oil and water separator ⑥
- Flexible hoses ⑦

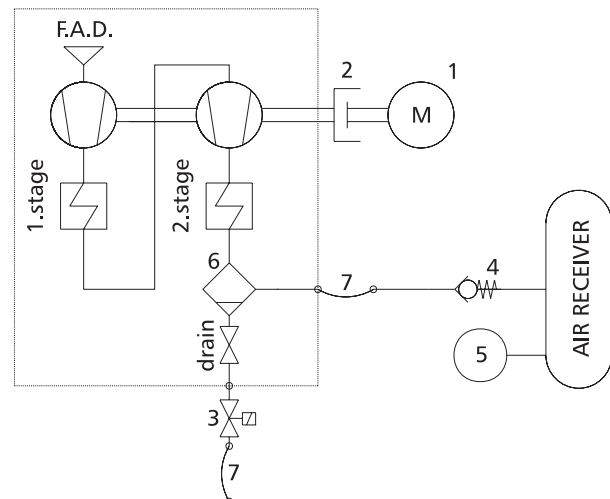

Illustrations, technical data, weights and dimensions are subject to alteration without previous notice.